



PRESENTS

INQUIZITIVE

General Rules

- ▶ Audience members are requested to maintain silence during the quiz.
- ▶ No External assistance allowed.
- ▶ Quiz masters decision would be considered final.
- ▶ There are 3 rounds and after each round there will be an audience question. Chocolates for the correct answer.
- ▶ For each round, the first team to answer the question would be decided by a lottery draw.
- ▶ Please wait for your turn to answer. Answering before your turn would result in **-10** from score.



LETS START..

ALL THE BEST

Round 1 Rules

- ▶ Read the questions carefully.
- ▶ Each question carries 5 marks.
- ▶ Your time will start as soon as the question is displayed. 3 minutes to read and solve the question. After 3 min you'll be asked to answer. No extra time will be given. You need to pass the question to next team.
- ▶ The passed question carries 3 marks. Teams need to answer the passed question in 10s.
- ▶ If all 6 teams don't answer a question. The audience gets the chance to answer.

QUESTION 1

Count the total number of squares in the figure shown

Write your answer on the paper provided.

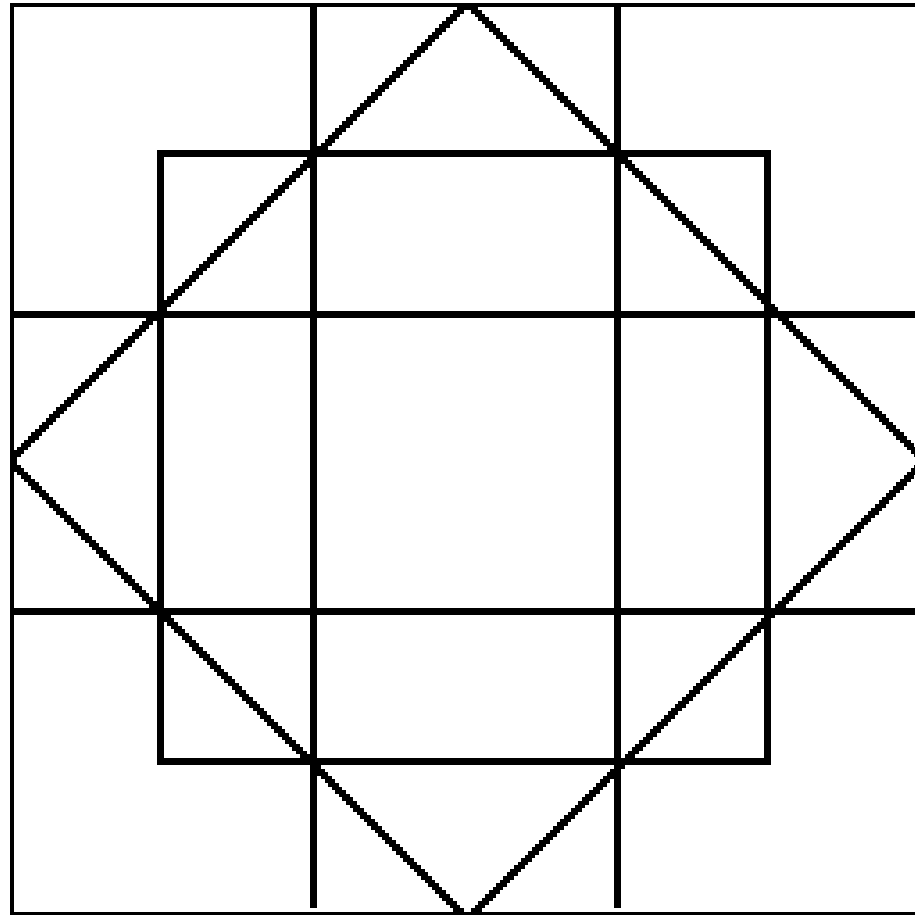

QUESTION 2

- ▶ Using the digits 1 up to 9, three numbers (of three digits each) can be formed, such that the second number is twice the first number, and the third number is three times the first number. The digits should be unique and can't be repeated. Cover all digits.

Which are these three numbers?

QUESTION 3

- ▶ Joyce has bought ten trees for her garden. She wants to plant these trees in five rows, with four trees in each row.

How must Joyce plant the trees?

QUESTION 4

- ▶ 100 people standing in a circle in an order 1 to 100. No. 1 has a sword. He kills the next person (i.e. No. 2) and gives the sword to the next (i.e. No. 3). All people do the same until only 1 survives.

Which number survives at the last?

QUESTION 5

- ▶ A blind-folded man is handed a deck of 52 cards and told that exactly 10 of these cards are facing up. He is asked to divide those cards into two piles, each with the same number of cards facing up. He can't peek, get help, or damage the cards, but may use any strategy that occurs to him to do so.

How can he do it?

QUESTION 6

- ▶ The shape shown must be partitioned into four identical pieces:

**Draw your
answer on the
paper provided.**

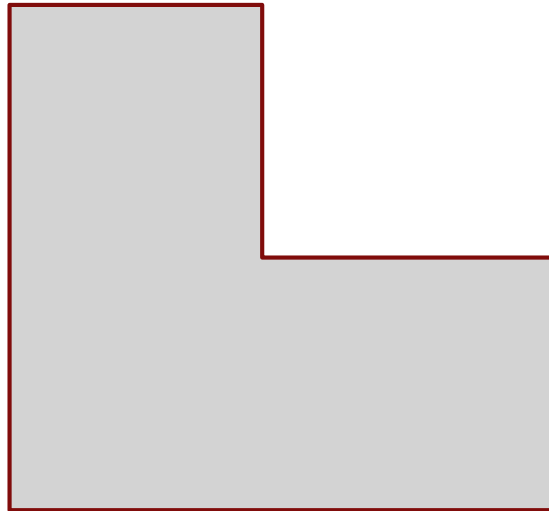

Round 2 Rules

- ▶ Identify the person in the image.
- ▶ Correct answer fetches you 3 marks. 1 mark for somewhat related answer.
- ▶ You get 10s to answer. Your time will start as soon as the question is displayed.
- ▶ The passed question carries 1.5 marks. Teams need to answer the passed question immediately.
- ▶ If all 6 teams don't answer a question. The audience gets the chance to answer.

QUESTION 7



QUESTION 8



QUESTION 9



QUESTION 10



QUESTION 11

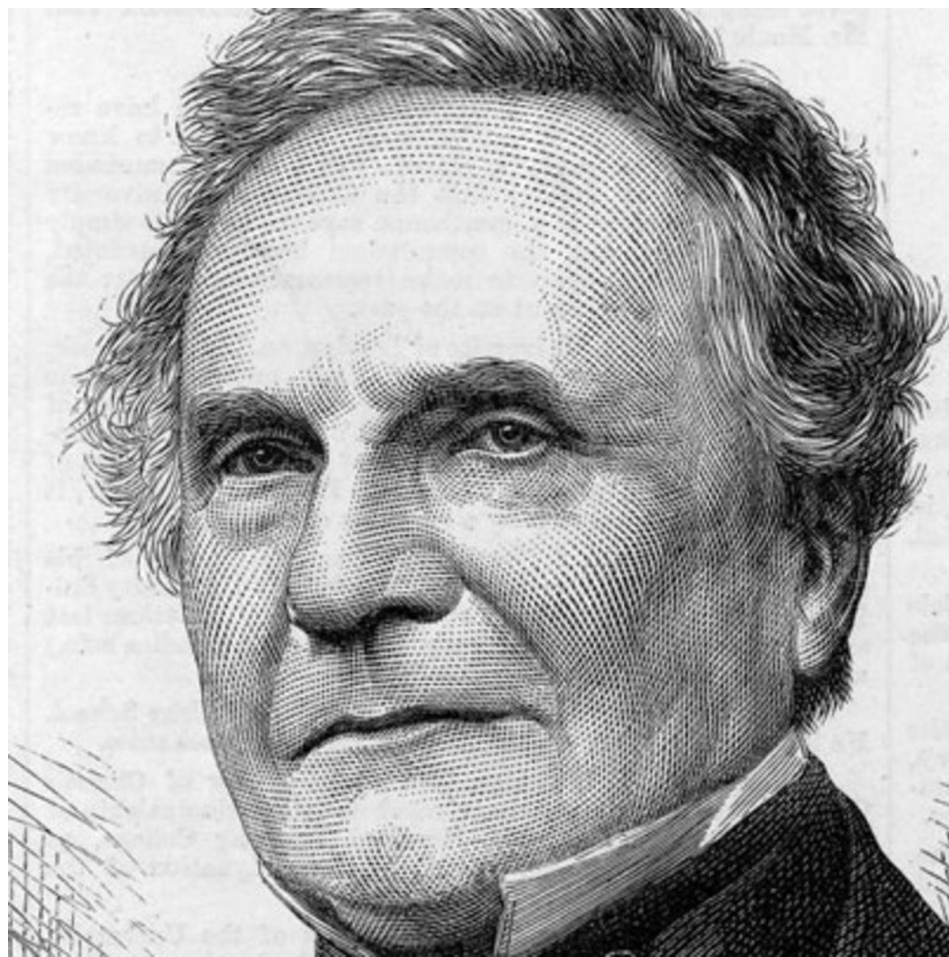

QUESTION 12

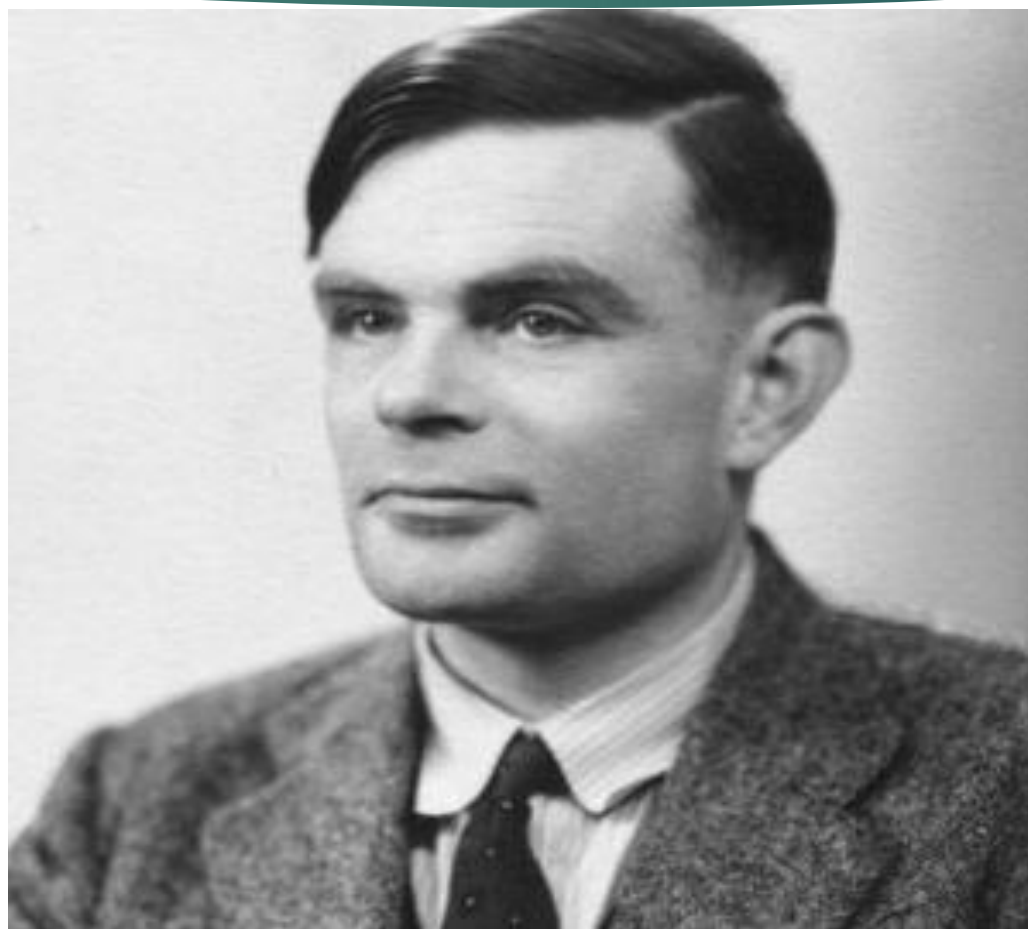

Round 3 Rules

- ▶ Examine the pattern carefully.
- ▶ Each question carries 4 marks.
- ▶ You have to write the answer on a paper and display to the quiz master when asked. Do not share or shout your answers.
- ▶ Your time will start as soon as the question is displayed. 2.5 minutes to read and solve the question. No extra time will be given.
- ▶ The passed question carries 2 marks. Teams need to answer the passed question in 10s.

QUESTION 13

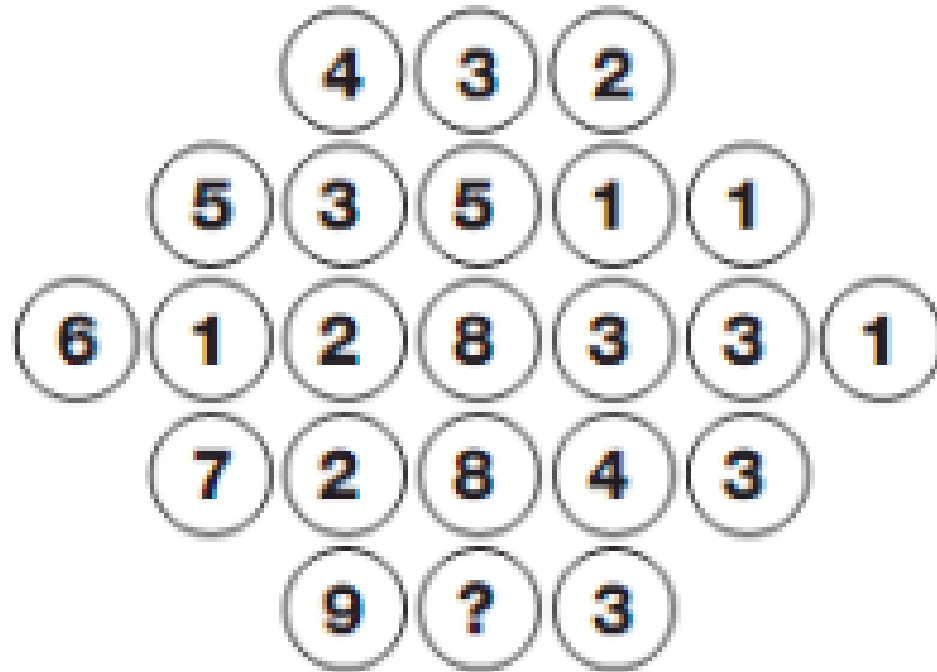

(a) 9

(b) 6

(c) 5

(d) 4

QUESTION 14



(a) 13

(b) 31

(c) 12

(d) 21

QUESTION 15

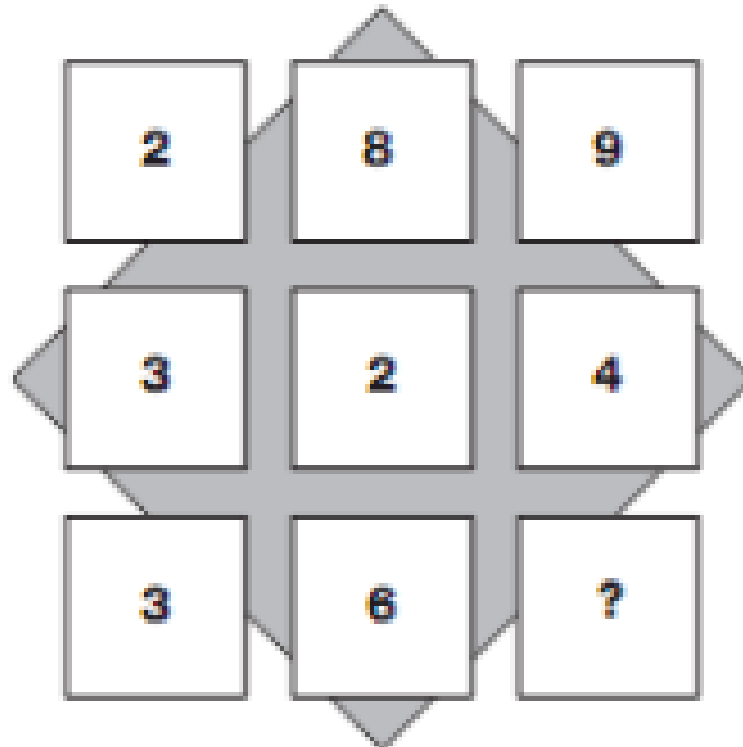

(a) 3

(b) 1

(c) 5

(d) 9

QUESTION 16

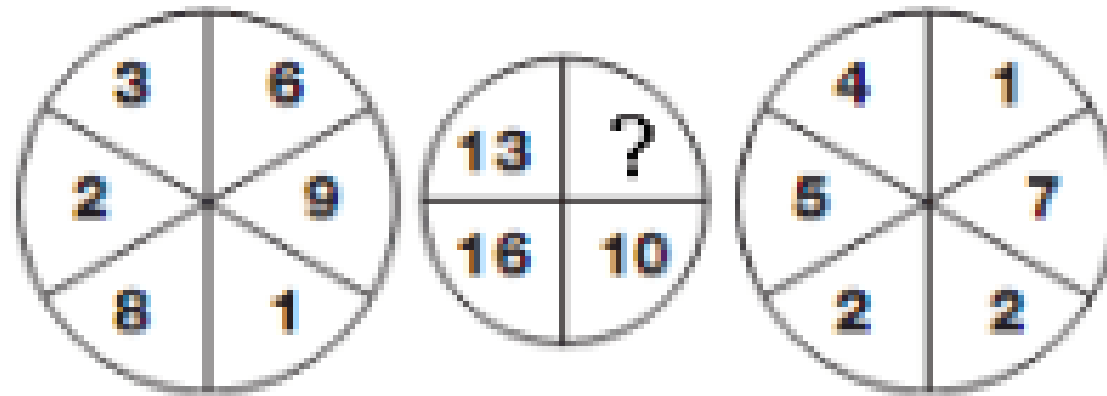

(a) 14

(b) 23

(c) 11

(d) 13

QUESTION 17

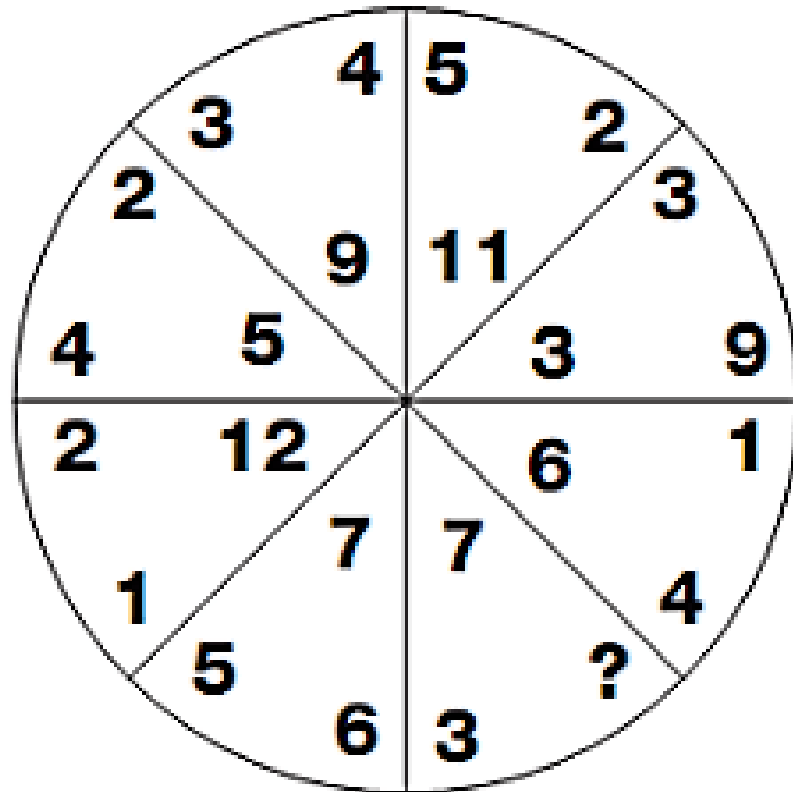

(a) 6

(b) 4

(c) 8

(d) 11

QUESTION 18

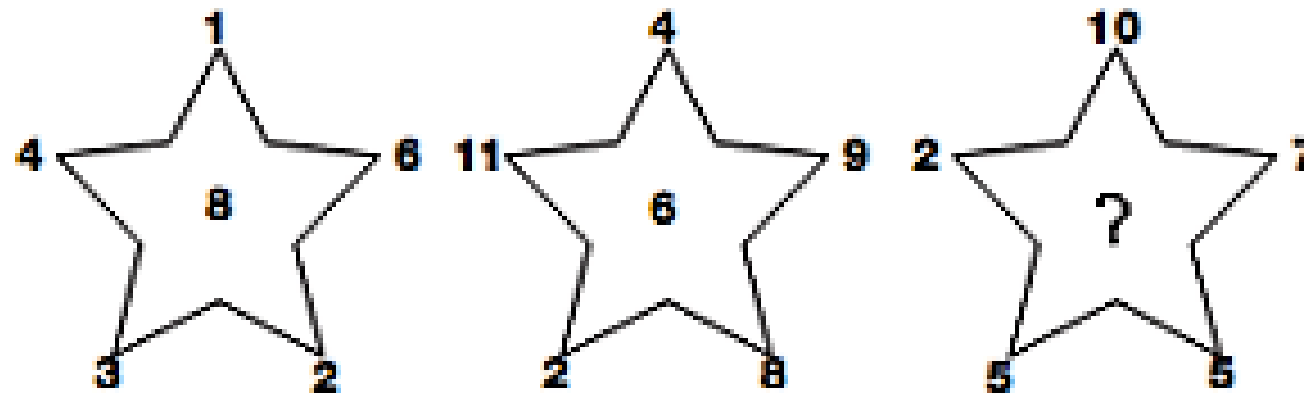

(a) 6

(b) 7

(c) 9

(d) 5



THANK YOU



Answers :-

1. 24
2. 192, 384, 576 or
219,438,657 or
273,546,819 or
327,654,981
3. 3. Shape of star
4. 73
5. Separate 2 decks one with 42 cards and other with 10 cards. Flip all the 10 cards of second pile.
- 6.

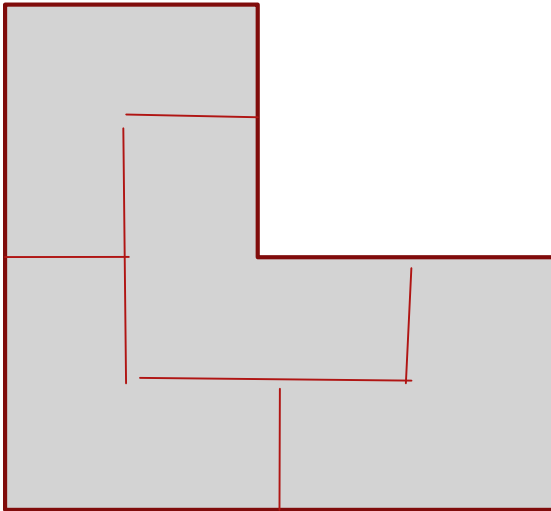

7. Jack Dorsey
8. Marissa Mayer

- 
9. Steve Wozniak
 10. Sabeer Bhatia
 11. Charles Babbage
 12. Alan Turing

13. 6

14. 13

15. 1

16. 11

17. 6

18. 5